

PREMIUM PLASTIC LITHIUM & ALKALINE CELL HOLDERS

For "1/2AA" · "AA" · "2/3A"



SHOWN WITH OPTIONAL RETAINER COVER INSTALLED



1029C RETAINER COVER



108C, 1028C & 1029LC RETAINER COVER

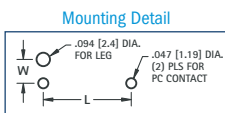
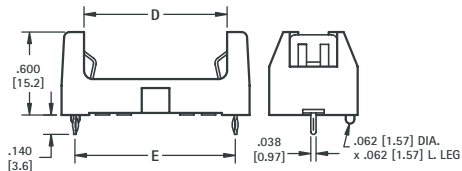
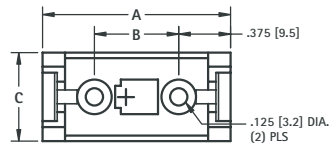

SPECIFICATIONS

Base: PBT, UL Rated 94V-0

Retainer Cover: PBT, UL Rated 94V-0

Contacts: .012 (.30) thick Spring Steel, Tin Nickel Plate

FEATURES

- Snap-In PC contact holds in position for wave soldering
- Tin Nickel Plated contacts for excellent solderability and durability
- Polarity clearly marked for orientation
- Low Profile, space-saving
- Snap-on retainer cover (optional) retains battery securely to withstand shock and vibration. Helps protect against shorting. Tamper-proof.

APPLICATIONS

- Computer memory, power transfer and back-up systems
- Video and telecommunications power back-up requirements
- Preprogrammed video and electronic games
- Microprocessor, microcomputers, minicomputers, notebook, laptop and handheld computer memory hold applications
- Emergency power systems
- Residential, industrial and commercial security and fire alarm systems

HOLDER CAT. NO.	COVER CAT. NO.	DIMENSIONS					MTG HOLES		CELL SIZE	BATTERY CROSS REFERENCE
		A (MAX)	B	C	D	E	L	W		
108	108C	1.360 (34.5)	.610 (15.5)	.640 (16.3)	1.030 (26.2)	1.160 (29.5)	1.160 (29.5)	.279 (7.1)	"1/2 AA"	Eveready: 544, Duracell: PX28L, Kodak: K28A & KS28, Panasonic: CR14250, Saft: LCP3, Electrochem: 3B955, Maxell: 4LR44, Sanyo: CR14250SE
1028	1028C	2.360 (59.9)	1.610 (40.9)	.640 (16.3)	2.030 (51.6)	2.160 (54.9)	2.160 (54.9)	.279 (7.1)	"AA"	Eveready: E9, EV15, E91, E177, 505, 1015, Duracell: ZM9, NC15, M15F, TR177, M505, MN1500, PC1500, Panasonic: UM-3 & P-45AA, Sanyo: N-600AA & N-700AA, Rayovac: 5AA, 7AA, 615, 815
1029	1029C 1029LC	1.700 (43.2)	.950 (24.1)	.720 (18.3)	1.375 (34.9)	1.500 (38.1)	1.500 (38.1)	.320 (8.1)	"2/3 A"	Duracell: DL2/3A, Panasonic: CR123A, Saft: 450SC & VR0450, Electrochem: 3B793 & 3B950, Sanyo: CR17335SE, Kodak: K123L

RUGGED STEEL & ALUMINUM LITHIUM CELL HOLDERS

STEEL HOLDERS



FIG. 1



FIG. 2

- Available in steel and aluminum
- Ideal for punishing applications
- Sturdily constructed of quality materials
- Contacts made from Brass, Nickel Plate

ADDITIONAL SPECIFICATIONS

Steel Holders: Refer to page 13
Aluminum Holders: Refer to page 15

ALUMINUM HOLDERS

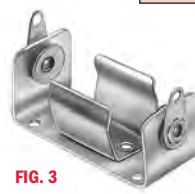

FIG. 3

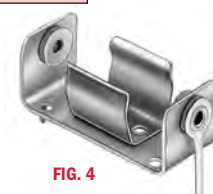
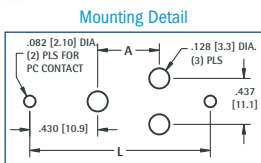
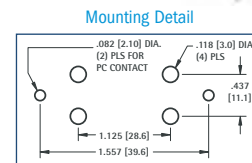

FIG. 4



STD LUGS CAT. NO.	FIG. NO.	PC LUGS CAT. NO.	FIG. NO.	BATTERY SIZE	BATTERY DIA.	DURA-CELL	PANA-SONIC	SANYO (G.E.)
1103	2	2103	1	"1/2 AA"	.510 × .990 (13.0 × 25.1)	P × 28L	CR14250	CR14250SE
1105	2	2105	1	"1/2 A"	.611 × .866 (15.5 × 22.0)	-	BR-1/2A	-
132	3	131	4	"2/3 A"	.661 × 1.315 (16.8 × 33.4)	DL-2/3A	BR-2/3A	CR17335SE



6 VOLT LITHIUM CELL HOLDERS

224



223



- Polarizing Tab for proper orientation
- Lightweight, ideal for rugged applications
- DL223A or Equivalent Batteries

SPECIFICATIONS

Frame: Aluminum 2024-T3 **Terminals:** Brass, Tin Plate

Spring Contacts: .025 (.64) Dia. Spring Steel, Nickel Plate

PC Terminals

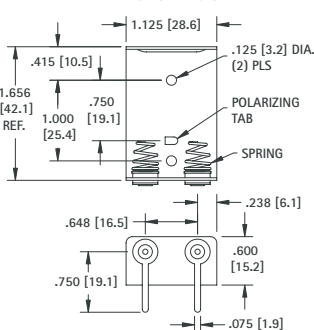

CAT. NO. 224

Quick Fit/Solder Lug

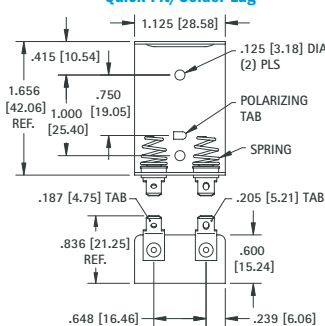

CAT. NO. 223

LITHIUM BATTERY HOLDERS